

Our Ref: DC/14/0366/FUL

Date: 13th February 2014

Case Officer: Adine Schrankel

Dial Direct: (01394) 444507

E-mail: d.c.admin@suffolkcoastal.gov.uk

Mr M Green - Clerk
Melton Town/Parish Council
PO Box 323
WOODBIDGE
IP12 9DQ

Dear Sir/Madam

I enclose details of the following planning application and would be pleased to receive the Town/Parish Council's observations by 5th March 2014.

Proposal: Change of use of 1 room only in outbuilding (coach house) from residential to commercial (office B1A). Mixed use for whole building as the remaining rooms will remain for residential use.

Address: The Retreat, Saddlemakers Lane, Melton

Town/Parish: Melton

File ref: DC/14/0366/FUL

Agent

Mr And Mrs Thompson
The Retreat
Saddlemakers Lane
Melton
Suffolk
IP12 1LZ

Applicant

Mr And Mrs Thompson
The Retreat
Saddlemakers Lane
Melton
Suffolk
IP12 1LZ

Yours faithfully,
Head of Planning Services

Recommendation (please give reasons for any refusal)

Other Observations (If any)

Date:

Signed:

Town/Parish Clerk

Planning and Coastal Management

Melton Hill, Woodbridge, Suffolk IP12 1AU

Telephone: (01394) 383789, E-mail: d.c.admin@suffolkcoastal.gov.uk

Fax: (01394) 385100, DX: Woodbridge 41400

Website: www.suffolkcoastal.gov.uk

Suffolk Coastal District Council
Melton Hill, Woodbridge, Suffolk IP12 1AU
Tel: 01394 444403/444423/444428
Fax: 01394 385100
Email: dc.admin@suffolkcoastal.gov.uk

SCDC
Received
- 8 FEB 2011
4:00 PM
Address

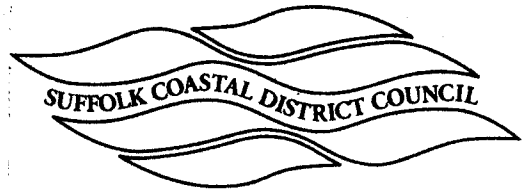

Application for Planning Permission. Town and Country Planning Act 1990

You can complete and submit this form electronically via the Planning Portal by visiting www.planningportal.gov.uk/apply

Publication of applications on planning authority websites

Please note that the information provided on this application form and in supporting documents may be published on the Authority's website. If you require any further clarification, please contact the Authority's planning department.

Please complete using block capitals and black ink.

It is important that you read the accompanying guidance notes as incorrect completion will delay the processing of your application.

1. Applicant Name and Address

Title: First name:
Last name:
Company (optional):
Unit: House number: House suffix:
House name:
Address 1:
Address 2:
Address 3:
Town:
County:
Country:
Postcode:

2. Agent Name and Address

Title: First name:
Last name:
Company (optional):
Unit: House number: House suffix:
House name:
Address 1:
Address 2:
Address 3:
Town:
County:
Country:
Postcode:

3. Description of the Proposal

Please describe the proposed development, including any change of use:

Change of use of 1 room only in outbuilding (coachhouse) from residential to commercial (office B1A). Mixed use for whole building as the remaining rooms will remain for residential use.

Has the building, work or change of use already started?

Yes

No

If Yes, please state the date when building, work or use were started (DD/MM/YYYY):

(date must be pre-application submission)

Has the building, work or change of use been completed?

Yes

No

If Yes, please state the date when the building, work or change of use was completed: (DD/MM/YYYY):

(date must be pre-application submission)

4. Site Address Details

Please provide the full postal address of the application site.

Unit: House number: House suffix:

House name:

Address 1:

Address 2:

Address 3:

Town:

County:

Postcode (optional):

Description of location or a grid reference.
(must be completed if postcode is not known):

Easting: Northing:

Description:

Outbuilding within curtilage of
developing house

5. Pre-application Advice

Has assistance or prior advice been sought from the local authority about this application? Yes No

If Yes, please complete the following information about the advice you were given. (This will help the authority to deal with this application more efficiently).

Please tick if the full contact details are not known, and then complete as much as possible:

Officer name:

Reference:

Date (DD/MM/YYYY):
(must be pre-application submission)

Details of pre-application advice received?

6. Pedestrian and Vehicle Access, Roads and Rights of Way

Is a new or altered vehicle access proposed to or from the public highway? Yes No

Is a new or altered pedestrian access proposed to or from the public highway? Yes No

Are there any new public roads to be provided within the site? Yes No

Are there any new public rights of way to be provided within or adjacent to the site? Yes No

Do the proposals require any diversions /extinguishments and/or creation of rights of way? Yes No

If you answered Yes to any of the above questions, please show details on your plans/drawings and state the reference of the plan (s)/drawings(s)

7. Waste Storage and Collection

Do the plans incorporate areas to store and aid the collection of waste? Yes No

If Yes, please provide details:

Have arrangements been made for the separate storage and collection of recyclable waste? Yes No

If Yes, please provide details:

8. Authority Employee / Member

With respect to the Authority, I am: (a) a member of staff
(b) an elected member
(c) related to a member of staff
(d) related to an elected member

Do any of these statements apply to you? Yes No

If Yes, please provide details of the name, relationship and role

9. Materials

If applicable, please state what materials are to be used externally. Include type, colour and name for each material:

	Existing (where applicable)	Proposed	Not applicable	Don't Know
Walls			<input checked="" type="checkbox"/>	<input type="checkbox"/>
Roof			<input checked="" type="checkbox"/>	<input type="checkbox"/>
Windows			<input checked="" type="checkbox"/>	<input type="checkbox"/>
Doors			<input checked="" type="checkbox"/>	<input type="checkbox"/>
Boundary treatments (e.g. fences, walls)			<input checked="" type="checkbox"/>	<input type="checkbox"/>
Vehicle access and hard-standing			<input checked="" type="checkbox"/>	<input type="checkbox"/>
Lighting			<input checked="" type="checkbox"/>	<input type="checkbox"/>
Others (please specify)	Additional low fence to surround parking area within site.		<input type="checkbox"/>	<input type="checkbox"/>

Are you supplying additional information on submitted plan(s)/drawing(s)/design and access statement?

Yes

No

If Yes, please state references for the plan(s)/drawing(s)/design and access statement:

- ① Floor plan of Coach House, upstairs + downstairs
 ② Design + Access Statement
 ③ Photos of Exterior
 ④ Site layout plan
 ⑤ Site Location Map

10. Vehicle Parking

Please provide information on the existing and proposed number of on-site parking spaces:

Type of Vehicle	Total Existing	Total proposed (including spaces retained)	Difference in spaces
Cars	4	0	0
Light goods vehicles/ public carrier vehicles	/	/	/
Motorcycles	/	/	/
Disability spaces	/	/	/
Cycle spaces	/	/	/
Other (e.g. Bus)	/	/	/
Other (e.g. Bus)	/	/	/

11. Foul Sewage

Please state how foul sewage is to be disposed of:

- Mains sewer
- Cess pit
- Septic tank
- Other
- Package treatment plant

Are you proposing to connect to the existing drainage system? Yes No

If Yes, please include the details of the existing system on the application drawings and state references for the plan(s)/drawing(s):

[Handwritten: /]

12. Assessment of Flood Risk

Is the site within an area at risk of flooding? (Refer to the Environment Agency's Flood Map showing flood zones 2 and 3 and consult Environment Agency standing advice and your local planning authority requirements for information as necessary.)

- Yes
- No

If Yes, you will need to submit a Flood Risk Assessment to consider the risk to the proposed site.

Is your proposal within 20 metres of a watercourse (e.g. river, stream or beck)? Yes No

Will the proposal increase the flood risk elsewhere? Yes No

How will surface water be disposed of?

- Sustainable drainage system
- Existing watercourse
- Soakaway
- Pond/lake
- Main sewer

13. Biodiversity and Geological Conservation

To assist in answering the following questions refer to the guidance notes for further information on when there is a reasonable likelihood that any important biodiversity or geological conservation features may be present or nearby and whether they are likely to be affected by your proposals.

Having referred to the guidance notes, is there a reasonable likelihood of the following being affected adversely or conserved and enhanced within the application site, or on land adjacent to or near the application site?

a) Protected and priority species:

- Yes, on the development site
- Yes, on land adjacent to or near the proposed development
- No

b) Designated sites, important habitats or other biodiversity features:

- Yes, on the development site
- Yes, on land adjacent to or near the proposed development
- No

c) Features of geological conservation importance:

- Yes, on the development site
- Yes, on land adjacent to or near the proposed development
- No

14. Existing Use

Please describe the current use of the site:

Outbuilding currently used as adjunct to main house, auxiliary storage and workspace.uton bed upstairs for guests.

Is the site currently vacant? Yes No

If Yes, please describe the last use of the site:

[Handwritten: /]

When did this use end (if known)?
DD/MM/YYYY
(date where known may be approximate)

Does the proposal involve any of the following?
If yes, you will need to submit an appropriate contamination assessment with your application.

Land which is known to be contaminated? Yes No

Land where contamination is suspected for all or part of the site? Yes No

A proposed use that would be particularly vulnerable to the presence of contamination? Yes No

15. Trees and Hedges

Are there trees or hedges on the proposed development site? Yes No

And/or: Are there trees or hedges on land adjacent to the proposed development site that could influence the development or might be important as part of the local landscape character? Yes No

If Yes to either or both of the above, you may need to provide a full Tree Survey, at the discretion of your local planning authority. If a Tree Survey is required, this and the accompanying plan should be submitted alongside your application. Your local planning authority should make clear on its website what the survey should contain, in accordance with the current 'BS5837: Trees in relation to design, demolition and construction - Recommendations'.

16. Trade Effluent

Does the proposal involve the need to dispose of trade effluents or waste? Yes No

If Yes, please describe the nature, volume and means of disposal of trade effluents or waste

[Handwritten: /]

17. Residential Units (Including Conversion)

Does your proposal include the gain, loss or change of use of residential units? Yes No
 If Yes, please complete details of the changes in the tables below:

Proposed Housing							
Market Housing	Not known	Number of Bedrooms					Total
		1	2	3	4+	Unknown	
Houses	<input type="checkbox"/>						
Flats and maisonettes	<input type="checkbox"/>						
Live-work units	<input type="checkbox"/>						
Cluster flats	<input type="checkbox"/>						
Sheltered housing	<input type="checkbox"/>						
Bedsit/studios	<input type="checkbox"/>						
Unknown type	<input type="checkbox"/>						
Totals (a+b+c+d+e+f+g)=							

Existing Housing							
Market Housing	Not known	Number of Bedrooms					Total
		1	2	3	4+	Unknown	
Houses	<input type="checkbox"/>						
Flats and maisonettes	<input type="checkbox"/>						
Live-work units	<input type="checkbox"/>						
Cluster flats	<input type="checkbox"/>						
Sheltered housing	<input type="checkbox"/>						
Bedsit/studios	<input type="checkbox"/>						
Unknown type	<input type="checkbox"/>						
Totals (a+b+c+d+e+f+g)=							

Social Rented							
Social Rented	Not known	Number of Bedrooms					Total
		1	2	3	4+	Unknown	
Houses	<input type="checkbox"/>						
Flats and maisonettes	<input type="checkbox"/>						
Live-work units	<input type="checkbox"/>						
Cluster flats	<input type="checkbox"/>						
Sheltered housing	<input type="checkbox"/>						
Bedsit/studios	<input type="checkbox"/>						
Unknown type	<input type="checkbox"/>						
Totals (a+b+c+d+e+f+g)=							

Social Rented							
Social Rented	Not known	Number of Bedrooms					Total
		1	2	3	4+	Unknown	
Houses	<input type="checkbox"/>						
Flats and maisonettes	<input type="checkbox"/>						
Live-work units	<input type="checkbox"/>						
Cluster flats	<input type="checkbox"/>						
Sheltered housing	<input type="checkbox"/>						
Bedsit/studios	<input type="checkbox"/>						
Unknown type	<input type="checkbox"/>						
Totals (a+b+c+d+e+f+g)=							

Intermediate							
Intermediate	Not known	Number of Bedrooms					Total
		1	2	3	4+	Unknown	
Houses	<input type="checkbox"/>						
Flats and maisonettes	<input type="checkbox"/>						
Live-work units	<input type="checkbox"/>						
Cluster flats	<input type="checkbox"/>						
Sheltered housing	<input type="checkbox"/>						
Bedsit/studios	<input type="checkbox"/>						
Unknown type	<input type="checkbox"/>						
Totals (a+b+c+d+e+f+g)=							

Intermediate							
Intermediate	Not known	Number of Bedrooms					Total
		1	2	3	4+	Unknown	
Houses	<input type="checkbox"/>						
Flats and maisonettes	<input type="checkbox"/>						
Live-work units	<input type="checkbox"/>						
Cluster flats	<input type="checkbox"/>						
Sheltered housing	<input type="checkbox"/>						
Bedsit/studios	<input type="checkbox"/>						
Unknown type	<input type="checkbox"/>						
Totals (a+b+c+d+e+f+g)=							

Key worker							
Key worker	Not known	Number of Bedrooms					Total
		1	2	3	4+	Unknown	
Houses	<input type="checkbox"/>						
Flats and maisonettes	<input type="checkbox"/>						
Live-work units	<input type="checkbox"/>						
Cluster flats	<input type="checkbox"/>						
Sheltered housing	<input type="checkbox"/>						
Bedsit/studios	<input type="checkbox"/>						
Unknown type	<input type="checkbox"/>						
Totals (a+b+c+d+e+f+g)=							

Key worker							
Key worker	Not known	Number of Bedrooms					Total
		1	2	3	4+	Unknown	
Houses	<input type="checkbox"/>						
Flats and maisonettes	<input type="checkbox"/>						
Live-work units	<input type="checkbox"/>						
Cluster flats	<input type="checkbox"/>						
Sheltered housing	<input type="checkbox"/>						
Bedsit/studios	<input type="checkbox"/>						
Unknown type	<input type="checkbox"/>						
Totals (a+b+c+d+e+f+g)=							

Total proposed residential units (A+B+C+D)=

Total existing residential units (E+F+G+H)=

TOTAL NET GAIN or LOSS of RESIDENTIAL UNITS (Proposed Housing Grand Total - Existing Housing Grand Total):

18. All Types of Development: Non-residential Floorspace

Does your proposal involve the loss, gain or change of use of non-residential floorspace? Yes No

If you have answered Yes to the question above please add details in the following table:

Use class/type of use	Not applicable	Existing gross internal floorspace (square metres)	Gross internal floorspace to be lost by change of use or demolition (square metres)	Total gross internal floorspace proposed (including change of use)(square metres)	Net additional gross internal floorspace following development (square metres)
A1	<input type="checkbox"/>				
Shops	<input type="checkbox"/>				
Net tradable area:	<input type="checkbox"/>				
A2	<input type="checkbox"/>				
Financial and professional services	<input type="checkbox"/>				
A3	<input type="checkbox"/>				
Restaurants and cafes	<input type="checkbox"/>				
A4	<input type="checkbox"/>				
Drinking establishments	<input type="checkbox"/>				
A5	<input type="checkbox"/>				
Hot food takeaways	<input type="checkbox"/>				
B1 (a)	<input checked="" type="checkbox"/>	NIL	NIL	13.4	13.4
Office (other than A2)	<input type="checkbox"/>				
B1 (b)	<input type="checkbox"/>				
Research and development	<input type="checkbox"/>				
B1 (c)	<input type="checkbox"/>				
Light industrial	<input type="checkbox"/>				
B2	<input type="checkbox"/>				
General industrial	<input type="checkbox"/>				
B8	<input type="checkbox"/>				
Storage or distribution	<input type="checkbox"/>				
C1	<input type="checkbox"/>				
Hotels and halls of residence	<input type="checkbox"/>				
C2	<input type="checkbox"/>				
Residential institutions	<input type="checkbox"/>				
D1	<input type="checkbox"/>				
Non-residential institutions	<input type="checkbox"/>				
D2	<input type="checkbox"/>				
Assembly and leisure	<input type="checkbox"/>				
OTHER	<input type="checkbox"/>				
Please Specify	<input type="checkbox"/>				
Total		NIL	NIL	13.4	13.4

In addition, for hotels, residential institutions and hostels, please additionally indicate the loss or gain of rooms

Use class	Type of use	Not applicable	Existing rooms to be lost by change of use or demolition	Total rooms proposed (including changes of use)	Net additional rooms
C1	Hotels	<input type="checkbox"/>			
C2	Residential Institutions	<input type="checkbox"/>			
OTHER		<input type="checkbox"/>			
Please Specify		<input type="checkbox"/>	NIL	NIL	NIL

19. Employment

Please complete the following information regarding employees:

	Full-time	Part-time	Total full-time equivalent
Existing employees			
Proposed employees			

20. Hours of Opening

Please state the hours of opening for each non-residential use proposed:

Use	Monday to Friday	Saturday	Sunday and Bank Holidays	Not known
OFFICE (B1A)	08.00 - 18.00	—	—	—

21. Site Area

Please state the site area in hectares (ha)

0.7

22. Industrial or Commercial Processes and Machinery

Please describe the activities and processes which would be carried out on the site and the end products including plant, ventilation or air conditioning. Please include the type of machinery which may be installed on site:

Is the proposal a waste management development? Yes No

If the answer is Yes, please complete the following table:

	Not applicable	The total capacity of the void in cubic metres, including engineering surcharge and making no allowance for cover or restoration material (or tonnes if solid waste or litres if liquid waste)	Maximum annual operational throughput in tonnes (or litres if liquid waste)
Inert landfill	<input type="checkbox"/>		
Non-hazardous landfill	<input type="checkbox"/>		
Hazardous landfill	<input type="checkbox"/>		
Energy from waste incineration	<input type="checkbox"/>		
Other incineration	<input type="checkbox"/>		
Landfill gas generation plant	<input type="checkbox"/>		
Pyrolysis/gasification	<input type="checkbox"/>		
Metal recycling site	<input type="checkbox"/>		
Transfer stations	<input type="checkbox"/>		
Material recovery/recycling facilities (MRFs)	<input type="checkbox"/>		
Household civic amenity sites	<input type="checkbox"/>		
Open windrow composting	<input type="checkbox"/>		
In-vessel composting	<input type="checkbox"/>		
Anaerobic digestion	<input type="checkbox"/>		
Any combined mechanical, biological and/or thermal treatment (MBT)	<input type="checkbox"/>		
Sewage treatment works	<input type="checkbox"/>		
Other treatment	<input type="checkbox"/>		
Recycling facilities construction, demolition and excavation waste	<input type="checkbox"/>		
Storage of waste	<input type="checkbox"/>		
Other waste management	<input type="checkbox"/>		
Other developments	<input type="checkbox"/>		

Please provide the maximum annual operational throughput of the following waste streams:

Municipal	
Construction, demolition and excavation	
Commercial and industrial	
Hazardous	

If this is a landfill application you will need to provide further information before your application can be determined. Your waste planning authority should make clear what information it requires on its website.

23. Hazardous Substances

Does the proposal involve the use or storage of any of the following materials in the quantities stated below? Yes No Not applicable

If Yes, please provide the amount of each substance that is involved:

Acrylonitrile (tonnes) <input type="text"/>	Ethylene oxide (tonnes) <input type="text"/>	Phosgene (tonnes) <input type="text"/>
Ammonia (tonnes) <input type="text"/>	Hydrogen cyanide (tonnes) <input type="text"/>	Sulphur dioxide (tonnes) <input type="text"/>
Bromine (tonnes) <input type="text"/>	Liquid oxygen (tonnes) <input type="text"/>	Flour (tonnes) <input type="text"/>
Chlorine (tonnes) <input type="text"/>	Liquid petroleum gas (tonnes) <input type="text"/>	Refined white sugar (tonnes) <input type="text"/>

Other:

Other:

Amount (tonnes):

Amount (tonnes):

24. Ownership Certificates and Agricultural Land Declaration

One Certificate A, B, C, or D, must be completed with this application form

CERTIFICATE OF OWNERSHIP - CERTIFICATE A

Town and Country Planning (Development Management Procedure) (England) Order 2010 Certificate under Article 12

I certify/The applicant certifies that on the day 21 days before the date of this application nobody except myself/ the applicant was the owner* of any part of the land or building to which the application relates, and that none of the land to which the application relates is, or is part of, an agricultural holding**

NOTE: You should sign Certificate B, C or D, as appropriate, if you are the sole owner of the land or building to which the application relates but the land is, or is part of, an agricultural holding.

* "owner" is a person with a freehold interest or leasehold interest with at least 7 years left to run.

** "agricultural holding" has the meaning given by reference to the definition of "agricultural tenant" in section 65(8) of the Act.

Signed - Applicant:

Or signed - Agent:

Date (DD/MM/YYYY):



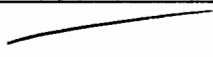

3/2/14

CERTIFICATE OF OWNERSHIP - CERTIFICATE B

Town and Country Planning (Development Management Procedure) (England) Order 2010 Certificate under Article 12

I certify/ The applicant certifies that I have/the applicant has given the requisite notice to everyone else (as listed below) who, on the day 21 days before the date of this application, was the owner* and/or agricultural tenant** of any part of the land or building to which this application relates.

* "owner" is a person with a freehold interest or leasehold interest with at least 7 years left to run.

** "agricultural tenant" has the meaning given in section 65(8) of the Town and Country Planning Act 1990

Name of Owner / Agricultural Tenant	Address	Date Notice Served

Signed - Applicant:

Or signed - Agent:

Date (DD/MM/YYYY):

24. Ownership Certificates and Agricultural Land Declaration (continued)

CERTIFICATE OF OWNERSHIP - CERTIFICATE C

Town and Country Planning (Development Management Procedure) (England) Order 2010 Certificate under Article 12

I certify/ The applicant certifies that:

- Neither Certificate A or B can be issued for this application
- All reasonable steps have been taken to find out the names and addresses of the other owners* and/or agricultural tenants** of the land or building, or of a part of it, but I have/ the applicant has been unable to do so.

* "owner" is a person with a freehold interest or leasehold interest with at least 7 years left to run.

** "agricultural tenant" has the meaning given in section 65(8) of the Town and Country Planning Act 1990

The steps taken were:

Name of Owner / Agricultural Tenant	Address	Date Notice Served

Notice of the application has been published in the following newspaper (circulating in the area where the land is situated):

On the following date (which must not be earlier than 21 days before the date of the application):

Signed - Applicant:

Or signed - Agent:

Date (DD/MM/YYYY):

CERTIFICATE OF OWNERSHIP - CERTIFICATE D

Town and Country Planning (Development Management Procedure) (England) Order 2010 Certificate under Article 12

I certify/ The applicant certifies that:

- Certificate A cannot be issued for this application
- All reasonable steps have been taken to find out the names and addresses of everyone else who, on the day 21 days before the date of this application, was the owner* and/or agricultural tenant** of any part of the land to which this application relates, but I have/ the applicant has been unable to do so.

* "owner" is a person with a freehold interest or leasehold interest with at least 7 years left to run.

** "agricultural tenant" has the meaning given in section 65(8) of the Town and Country Planning Act 1990

The steps taken were:

Notice of the application has been published in the following newspaper (circulating in the area where the land is situated):

On the following date (which must not be earlier than 21 days before the date of the application):

Signed - Applicant:

Or signed - Agent:

Date (DD/MM/YYYY):

25. Planning Application Requirements - Checklist

Please read the following checklist to make sure you have sent all the information in support of your proposal. Failure to submit all information required will result in your application being deemed invalid. It will not be considered valid until all information required by the Local Planning Authority has been submitted.

The original and 3 copies of a completed and dated application form:

- The correct fee:

The original and 3 copies of the plan which identifies the land to which the application relates drawn to an identified scale and showing the direction of North:

- The original and 3 copies of a design and access statement, if required (see help text and guidance notes for details):

The original and 3 copies of other plans and drawings or information necessary to describe the subject of the application:

- The original and 3 copies of the completed, dated Ownership Certificate (A, B, C or D - as applicable) and Article 12 Certificate (Agricultural Holdings):

26. Declaration

I/we hereby apply for planning permission/consent as described in this form and the accompanying plans/drawings and additional information. I/we confirm that, to the best of my/our knowledge, any facts stated are true and accurate and any opinions given are the genuine opinions of the person(s) giving them.

Signed - Applicant:

Or signed - Agent:

Date (DD/MM/YYYY):



3/2/14

(date cannot be pre-application)

27. Applicant Contact Details

Telephone numbers

Country code: National number: Extension number:

01394 389 503

Country code: Mobile number (optional):

07834 083 913

Country code: Fax number (optional):

Email address (optional):

BUFFY@GAESCAPE.CO.UK

28. Agent Contact Details

Telephone numbers

Country code: National number: Extension number:

Country code: Mobile number (optional):

Country code: Fax number (optional):

Email address (optional):

29. Site Visit

Can the site be seen from a public road, public footpath, bridleway or other public land? Yes No

If the planning authority needs to make an appointment to carry out a site visit, whom should they contact? (Please select only one)

Agent Applicant Other (if different from the agent/applicant's details)

If Other has been selected, please provide:

Contact name:

Telephone number:

Email address:

SCDC
Received
-3 FEB 2014

**Proposed change of use of One Downstairs Room in The Coach House at The Retreat,
Saddlemakers Lane, Melton, Woodbridge, IP12 1LZ
for Mr & Mrs S Thompson.**

Design and Access Statement

Current situation

The application building is the former coach house of 'The Retreat', a red brick detached 2-storey shed standing in the grounds of the main house, on the fringe of Melton village. Both 'The Retreat' and the former coach house are part of the whole property owned by the applicants.

The building, separate from the main house is plastered inside and has a loo downstairs in what was an outside shed and is otherwise a roof space upstairs which is reached by a ladder stairway and a main room downstairs with a small 'hallway' where the ladder stairs are plus access to the loo. It is used mainly as storage and informal workspace with futon bed upstairs for guests. It is not self-contained and is used as an addition to the main 2-bedroom house. It is approx. 20m from the main house down a path.

Building Condition

The building is in a sound structural condition.

Change of Use & Proposed Works

The owners see potential for the front downstairs room of the coach house only to provide a self-contained office which would meet the needs of a small locally-based business or voluntary / community sector organisation. This would be in addition to retaining the upstairs accommodation for visiting friends and relatives and as ancillary storage / working space for the owners.

No structural work is proposed. The front room would be cleared and re-painted anticipating its use as a small office, providing working space for no more than two people. Provision of a lock on the existing internal door would provide the necessary separation and security of the two parts of the building for their respective users.

The property is currently accessed by a short private drive leading off Saddlemakers Lane to a five-barred gate, beyond which lies the extensive garden and informal parking for approx. 4 cars. An additional low fence with gate will be erected to separate the current informal parking area from the garden and path to the main house.

Design

Other than the erection of a low fence, no external changes are proposed.

Access: Traffic & Transport Impact

It is proposed that any tenancy agreement for the proposed office would restrict the number of employees using the site to two, with a similar restriction on the number of car parking spaces allocated.

The site is accessible on foot and by cycle from Melton village centre, and less than 800 metres distant from the bus stop.

If approved, this proposal is unlikely to add more than 4 additional vehicle movements per day to traffic currently using Saddlemakers Lane. Visitors would be by appointment only and the current Parish Council office has very few visitors anyway.

The Parish Council Clerk and his assistant would use this office for no more than 2 days in the working week, with the proviso that this could increase to no more than 3 working days if the Parish Council decided later to increase working hours.

Disabled access

There is no explicit provision for access to the building by people with reduced mobility. However, as a ground floor office, it should not provide any impediment to access.

Consultation

There are no residential or commercial properties adjoining the site with whom to consult.

The owners are aware that the lease under which Melton Parish Council occupies their current office is due to expire shortly and that there is a lack of suitably sized accommodation at a price affordable to the council in the current financial climate. Informal discussion has taken place with the Parish Council and, should this application be approved, a formal lease will be drawn up between the owners and the council.

Countryside

Although this property is situated in the countryside the application is for change of use for 1 room only, for a maximum of 2 people to use and for no more than 3 days in the working week.

Tollgate Cottage on Yarmouth Road, which is close to this property and is also in the countryside, has recently had permission given for change of use so that a Physiotherapy Business can be run from it.

We only want change of use for 1 room and its use would be very restricted.

The Coach House (downstairs)

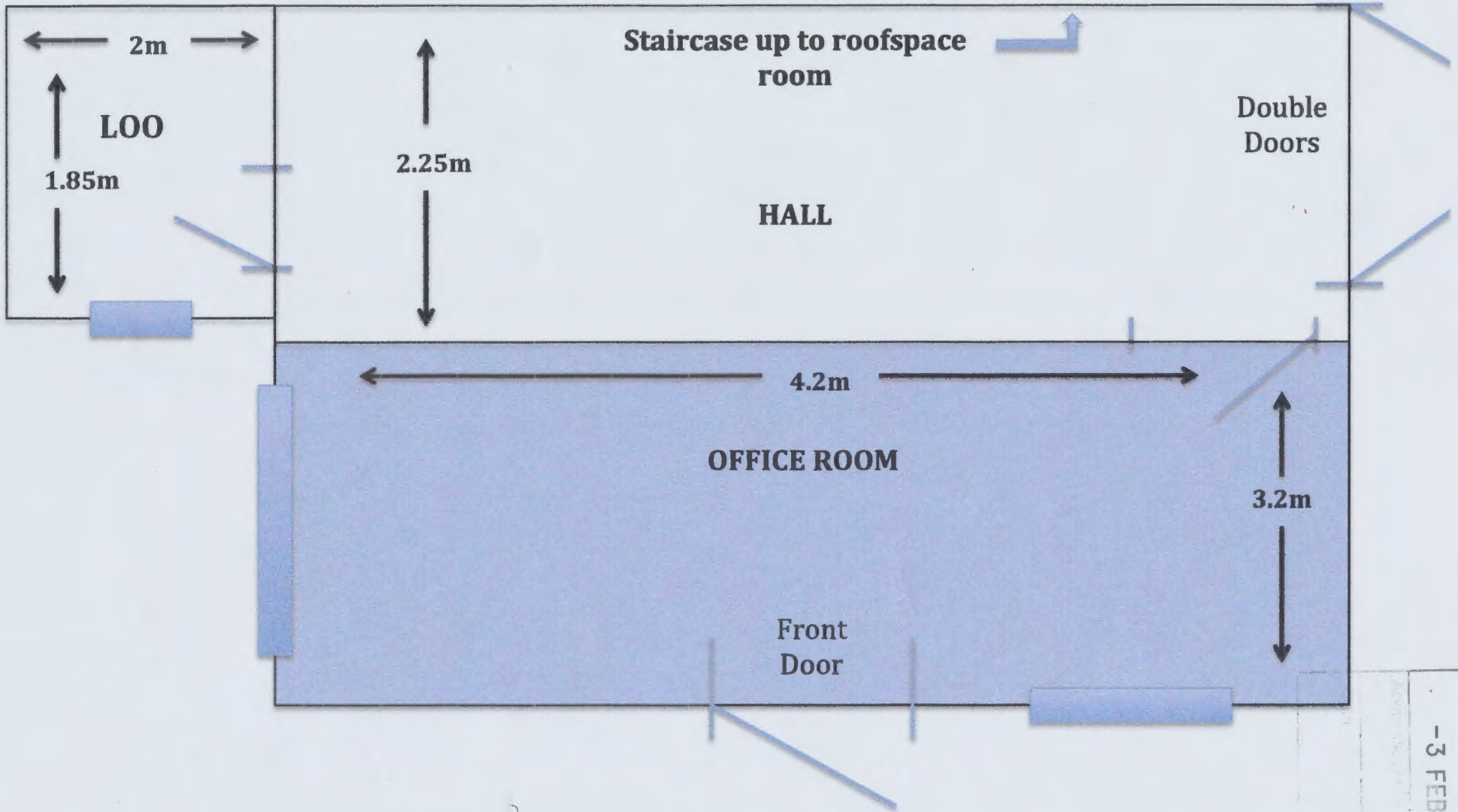

SCDC
Received
- 3 FEB 2014

The Coach House (upstairs)

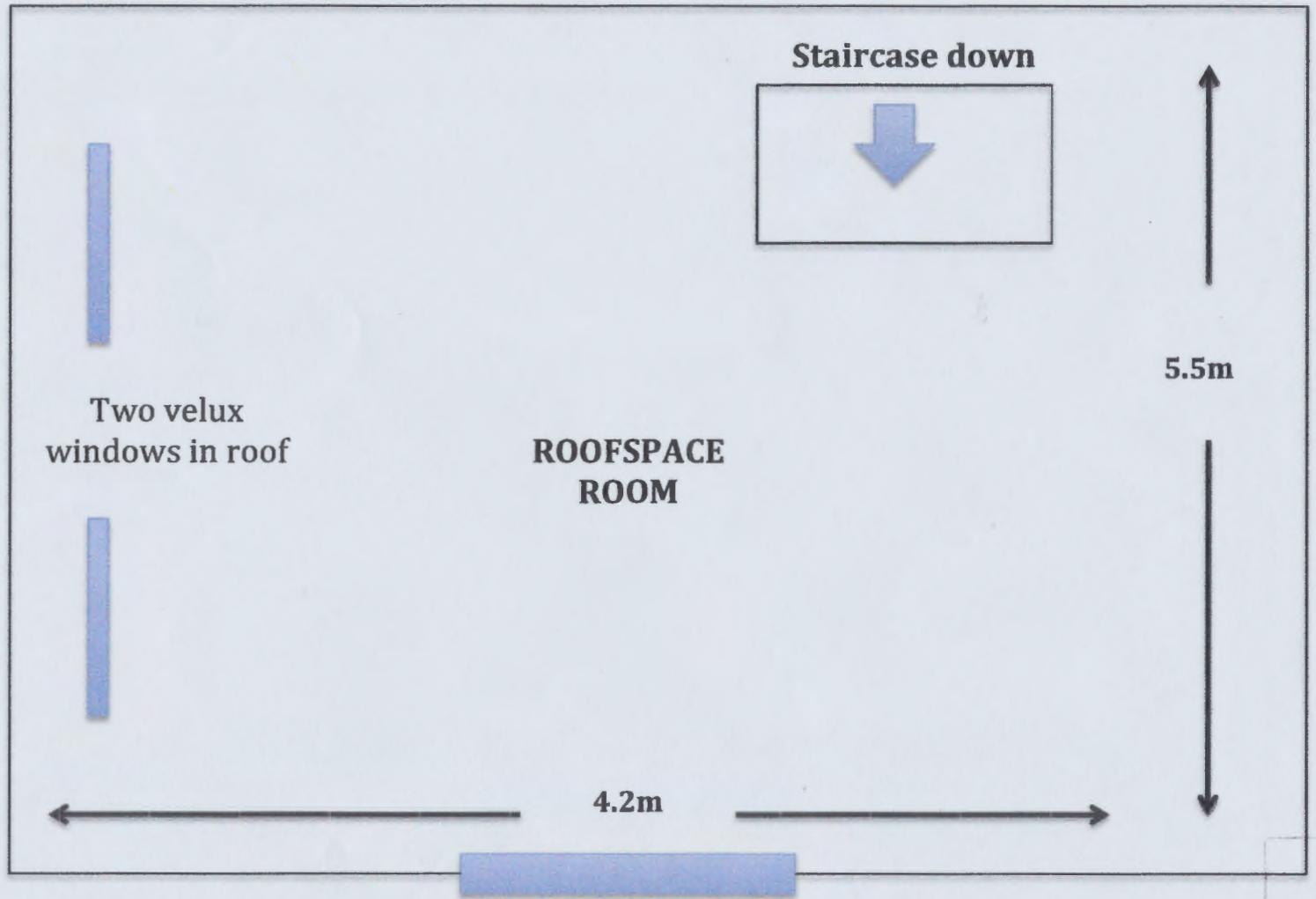



received
-3 FEB 2014
Action ...
...

SCDC	
Received	
-3 FEB 2014	
Approved	File Ref
Action	

New Road / Saddlemakers Lane

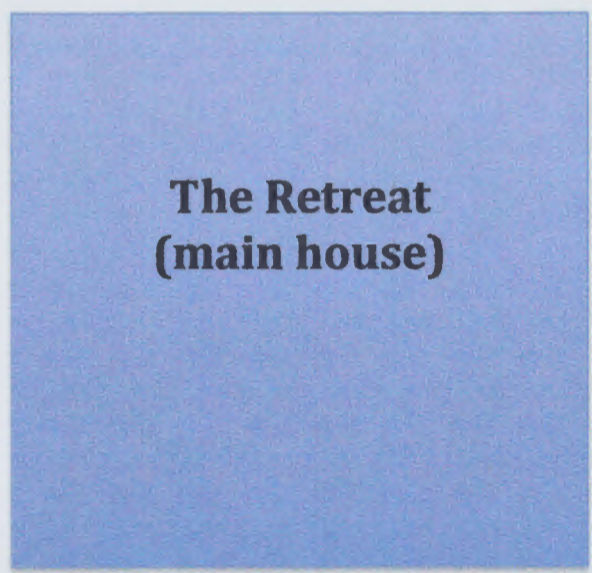

**The Retreat
(main house)**

Path

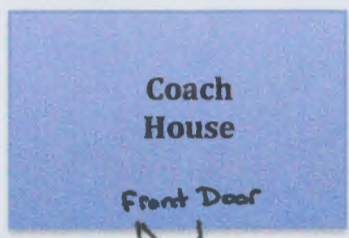

**Coach
House**

Front Door

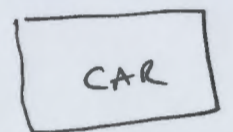

CAR

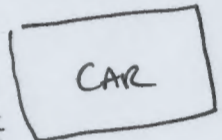

CAR

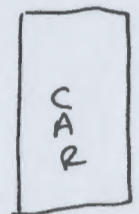

C
A
R

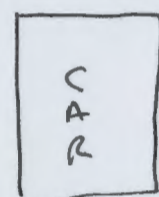

C
A
R

Proposed fence

Gate

GARDEN

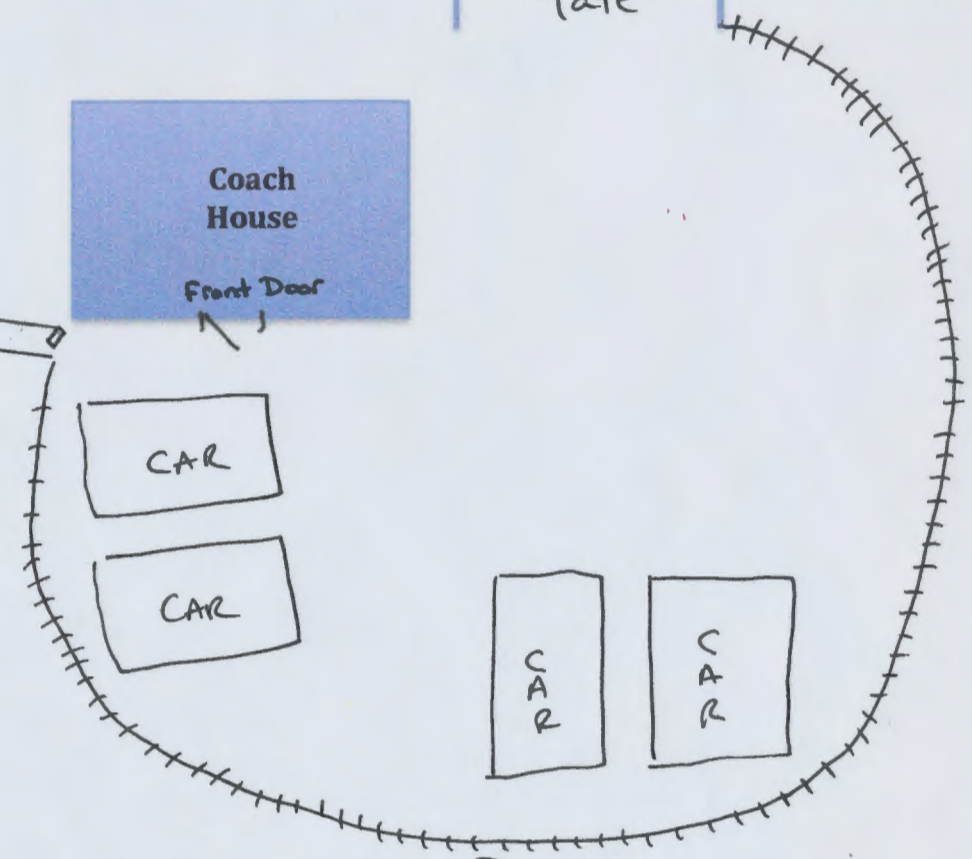



SCDC	
Received	
-3 FEB 2014	
Acknowledged	File Ref
Action	