



MELTON PARISH COUNCIL

MPC(22)96.06

Yarmouth Road Speed Repeater Roundels

Residents of Upper Melton Terrace attended the Planning & Transport meeting on the 7th September to express their concerns about speeding traffic on Yarmouth Road. I have been in contact with Highways and the police safety camera team to share their concerns.

A speed survey was carried out by the police in October and the results below show that it meets the criteria to become an enforcement site.

Report Sheet	Combined	Channel 1	Channel 2
Average Speed	34.8	32.9	36.4
85th Percentile	41	38	42
Total Number Of Vehicles	31294	14181	17110
Speed Limit	30	30	30
Number Over Speed Limit	24281	9274	15004
Percentage Over Speed Limit	77.6	65.4	87.7
NPCC	35	35	35
Number At Or Over NPCC	15131	4858	10271
Percentage At Or Over NPCC	48.4	34.3	60.0

Data collected between: 11:23 4/10/22 - 11:04 11/10/22

Site Number: 00002659

Location: B1438 Melton Yarmouth Rd opp No 1 Upper Melton Terrace on sign 154m in limit

Channel 1: From Ufford

Channel 2: From The Street

SCC Highways have proposed that 5 x 30mph roundels could be painted on Yarmouth Road to remind users of the existing speed restriction (see appendix A). The estimated cost is around £1,100 which covers the health and safety documentation, traffic management, the installation costs including drying of the road and VAT. Residents of Upper Melton Terrace have been notified of this proposal and support has been received from three households already.

Recommendations

Members are asked to:

- Note and comment on the report
- Agree if they wish to proceed with instructing Highways to paint 5 speed repeater roundels on Yarmouth Road to be funded from CIL.

Pip Alder

Clerk and Executive Officer to the Council

November 2022

Appendix A

File Path: R:\Transport & Infrastructure\Infrastructure Mgmt\Community Engagement and Minor Works Team\UHB Parish Files - August 2022 onwards\Wobur\New 30mph
 Plot date 03/11/2022

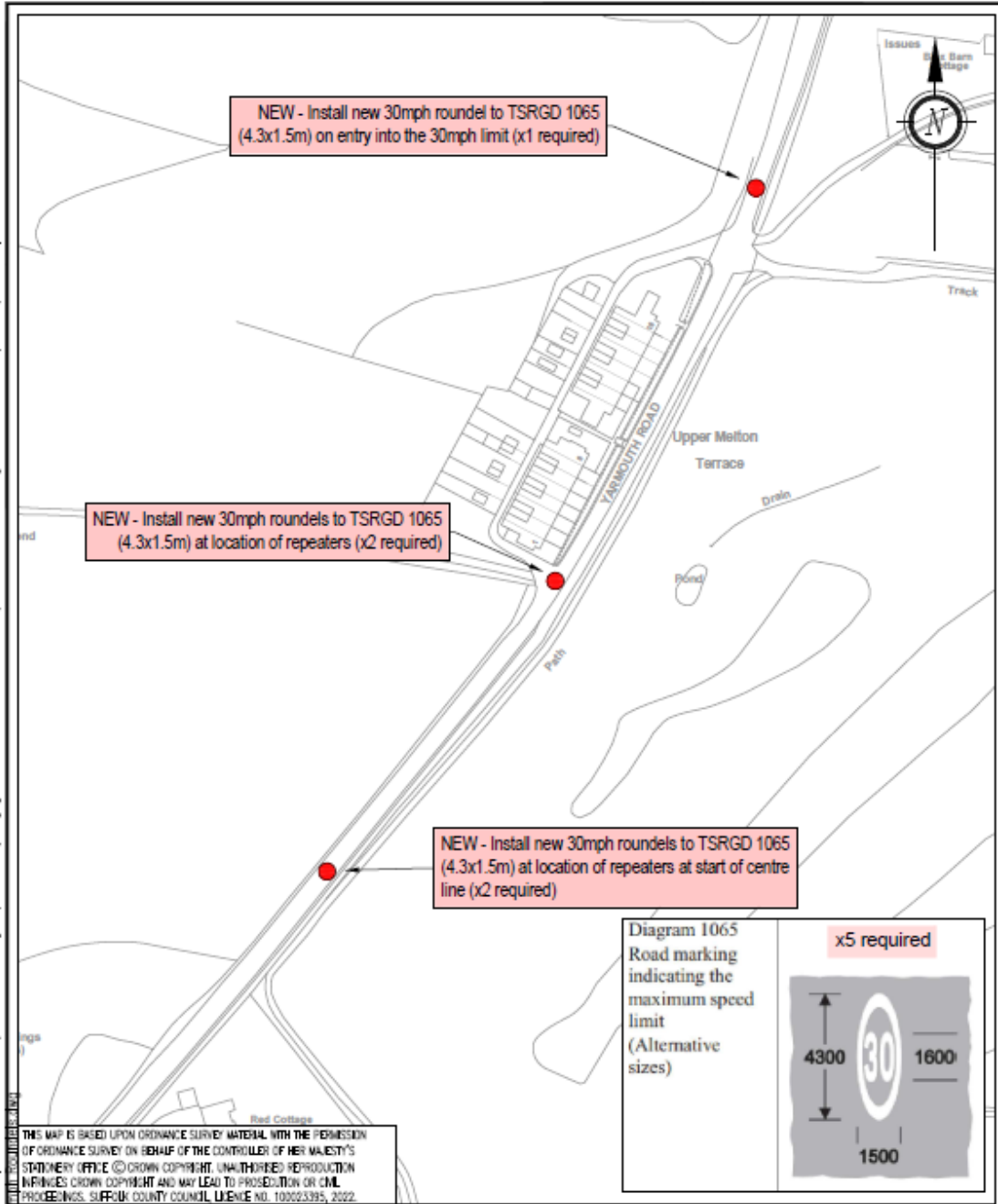

THIS MAP IS BASED UPON ORDNANCE SURVEY MATERIAL WITH THE PERMISSION OF ORDNANCE SURVEY ON BEHALF OF THE CONTROLLER OF HER MAJESTY'S STATIONERY OFFICE ©CROWN COPYRIGHT. UNAUTHORISED REPRODUCTION INFRINGES CROWN COPYRIGHT AND MAY LEAD TO PROSECUTION OR CIVIL PROCEEDINGS. SUFFOLK COUNTY COUNCIL, LICENSE NO. 100023395, 2022.

<p>Phoenix House, 3 Goddard Road, Ipswich, Suffolk IP1 6NP. Highways enquiries: 0346 808 8171 www.suffolk.gov.uk/highways</p>		REF. DATE INT.			
PROJECT TITLE YARMOUTH ROAD MELTON SUFFOLK		ORIGINATOR JWW	CHECKED	DESIGNED JWW	REVIEWER
SCALE(S) 1:2000		ORIG. DATE 11/11/2022		DATE NOVEMBER 2022	
DRAWING TITLE YARMOUTH ROAD - 30MPH ROUNDELS		DRAWING NUMBER SK-01		REVISION -	